

# CRAFTY CRITTERS: HOW TO DRAW A HEXAGON

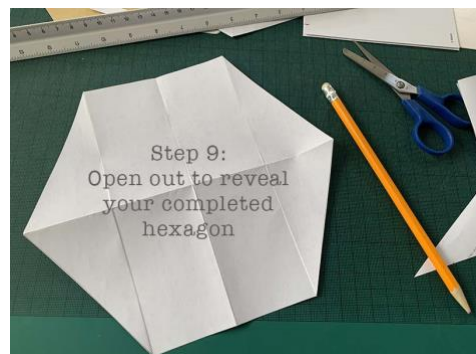
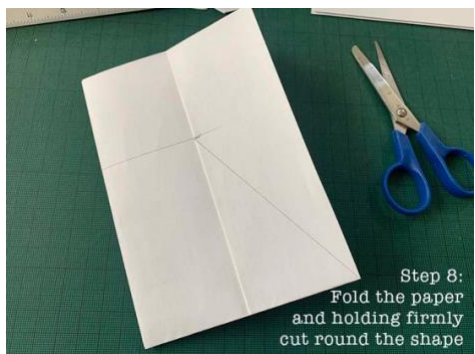
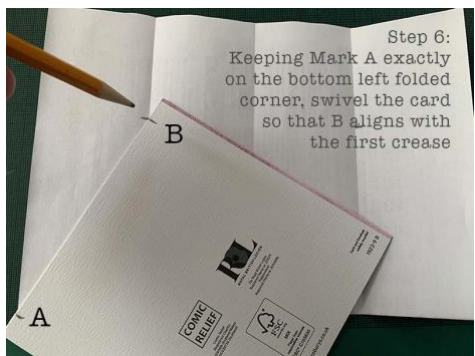
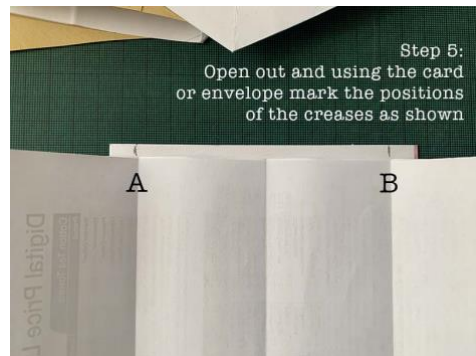
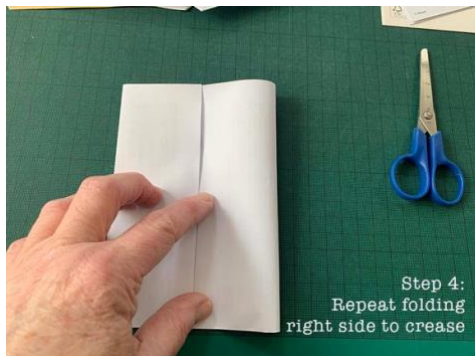
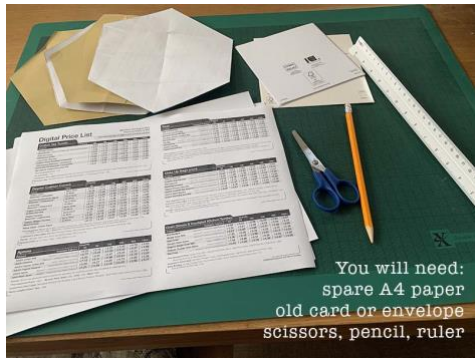

# CRAFTY CRITTERS: HOW TO DRAW A HEXAGON

## MATERIALS

You will need:

Spare A4 paper  
Old card or envelope  
Scissors  
Pencil  
Ruler

## STEPS

### Step 1:

Fold paper firmly in half so short sides meet

### Step 2:

With folded edge at the bottom (nearest you) fold paper firmly again so sides meet

### Step 3:

Open out and fold left side to middle crease line

### Step 4:

Now fold right side to middle crease line

### Step 5:

Open out and using the card or envelope, place it under the paper as shown and mark the positions of the first (A) and third (B) creases along the top edge of the card

### Step 6:

Position your card on the paper so that A aligns exactly with the bottom left corner and mark on your paper where B aligns with the first crease.

### Step 7:

Repeat this for the right hand side and using your ruler, draw lines to connect the dots and corners.

### Step 8:

Fold the paper along the middle crease and holding it firmly, cut round the shape.  
NOTE: if you find this tricky then cut round the shape at Step 7

### Step 9:

Open out to reveal your completed hexagon!